

Saola Captive Conservation and Breeding Centre

IUCN/SSC Saola Working Group

Total Area:
Animal: Saola
Budget:
Time frame: 2015 - present

*Saola
in habitat*

Concept Design

Working with IUCN Saola Working Group we developed a concept for a large center for endangered forest hoofstock species in the Annamite mountains of Laos, with an emphasis on the illusive Saola. The facility uses enclosed habitats to mitigate most threats to saola and to preserve critical wildlife populations. Additionally, the Centre has other important functions: a large capacity-building role for national staff working at the Centre and an enviroment to increase our knowledge of saola biology and behavior, which in turn, will improve conservation of the species in the wild.

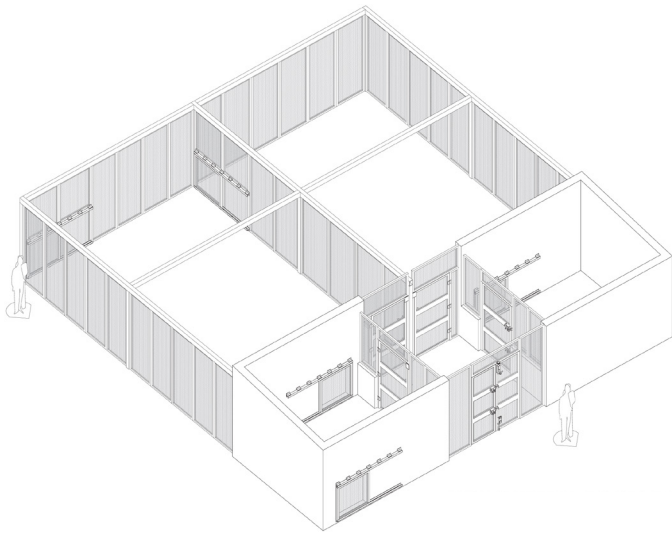

Saola habitat holding shelter

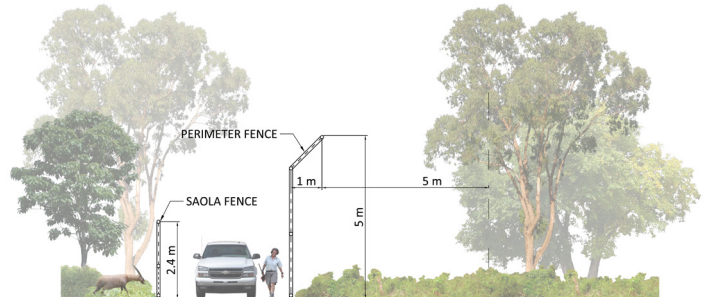
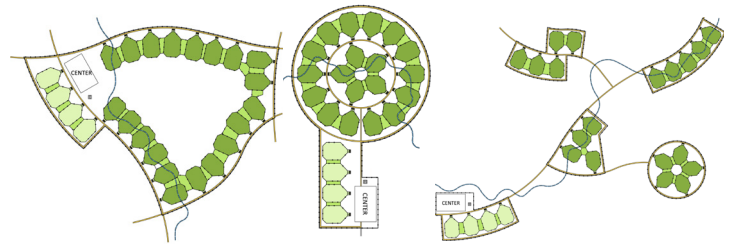

*Habitat layout alternatives, above
Habitat perimeter barrier, above*

